

Woodburning - Multifuel Stoves



CASHIN

2012 / 2013

Tradition - Charleston - Firejet





CASHIN

since 1978

Based in the centre of Europe in the foothills of the Vosges mountains, CASHIN ACADEMIE DU FEU is a family run business with very committed workers .

CASHIN was one of the first to introduce secondary burn in woodburning stoves in the late 70's.

In the 80's, our stoves were fitted with outside air connection for very well insulated houses (OSA system)

In the 90's, we were the first to introduce Pellet stoves in Europe (Oscar de la Nouveauté at the show in Paris 1994)

Thanks to 30 years of experience, we have developed a range of high-tech boiler stoves in order to comply with strict environmental norms.

Enjoy our brochure and please do not hesitate to contact us or one of our distributors for more information.

The C5





fire
life

L T4



The SUMMARY

CASHIN the company		06-07
“Charleston” Range		09-12
“Traditional” Range		13-15
“Firejet” Range		17-19

The company



CASHIN

*Our contribution
to your home
and life style.....*

The CASHIN stove is a piece of furniture both solid and efficient that will give years of satisfaction.

It offers a very advanced system of combustion: the heat generated being distributed by convection (broad distribution of warm air) plus warmth direct from the stove and it can also produce hot water.

The heat inside a Cashin stove (Charleston & Traditional) is delivered into the living area by a double skin creating a current of warm air and reducing the risk of overheating; hence it adds an element of protection for children...

The COMPANY

THE COMPANY



Warehouses, showrooms, offices, assembly plant and R & D are located in the foothills of the Vosges mountains and within sight of the Black Forest. The town of Orbey is situated between 550 and 1200 metres altitude.





CHARLESTON RANGE

The conception, design and architecture of this range is such that anyone would be pleased to give it house room.

Generous visibility of the fire, beautiful lines, practical side loading, a stove to be admired and enjoyed for years to come, and it's hybrid look bridges the 20 th and 21th century.

The Charleston Range,
“They don't come any better.”

The C4 & C5



C4



C5

This product integrates a very advanced combustion system with an air wash for the glass. The air intake is preheated and injected into the firebox through Primary, Intermediate, Secondary and Tertiary air ducts. All models can be fitted with a central heating boiler without reducing the combustion.

Sizzling hot air mixed with the fuel gases (wood or coal) provides a clean burn, higher efficiency and cheaper heating.

The warmth is distributed in different ways :

1. Direct hot air to all over in the living area (convection)
2. Radiant heat
3. Central heating and Domestic hot water when a boiler fitted; the holes are pre-punched and can be retro fitted at any time...

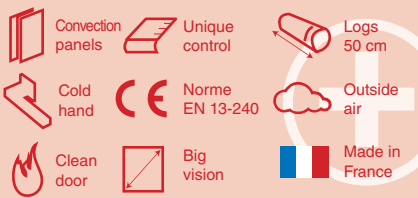



The C2 & C3



C2



C3

The Charleston C2 is the modern version of the Parlour stove. The powerful structure is a hint of good taste where real wealth whispers...

A great vision of the flame thanks to a big glass door !!

Both models come as Multi fuel stoves. The double skin (this is very unique in a cast iron product) reduces the risk of overheating. Special material is used to absorb the excess heat that is later released into living area.

The universal boiler can be used for an open or closed system and can be coupled with other energies e.g solar, electricity, oil & gas boiler, etc.

The C3 is a gentle giant, it has been remarked that it will make your home cosy during cold winter nights.

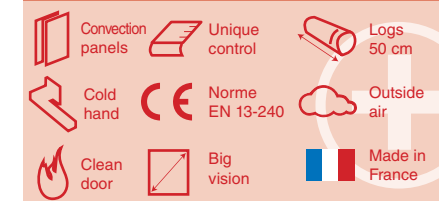



TRADITIONAL RANGE



TRADITIONAL RANGE

This range is a legacy to our know-how. We have been producing the Traditional range since the early 2001 and it has been very popular in various regions: French Alps, the South West of France...

Simple & traditional design which is perfect for farm houses or cottages. Despite the “traditional look” it integrates the very best of modern combustion technology!

The T4 & T5



T4



T5

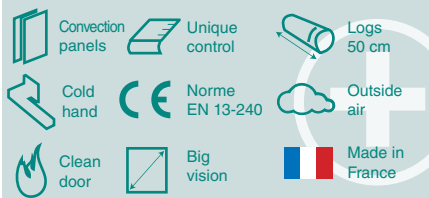

Our model T5 is a powerful stove that can be regulated between 4 and 18 KW and still burns clean.

The soapstone hob (an option) is a clever way of keeping the stove warm.

It is a combination of the right material in the right place: cast iron, 4 and 6 mm steel, long life bricks and vermiculite deflector with results equal to the best international standards.

These stoves are hand made to give a lifetime satisfaction!

The T2 & T3



T2



T3

All models in the Traditional range can be fitted with a high Tech boiler but also a thick soapstone top to be used as a simmering plate.

They come as standard with 'cold hand' handles and are very safe to use due to the high quality of manufacturing: airtight firebox with outside air connection, double wall construction to create convection and the surface is safer for small children.

The side door loading for longer logs is an added convenience.

Made in Alsace center, with the latest technology, all our models are tested by independent laboratories in Stuttgart or Munich, as well as other accredited European laboratories.

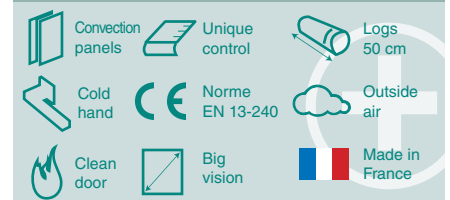

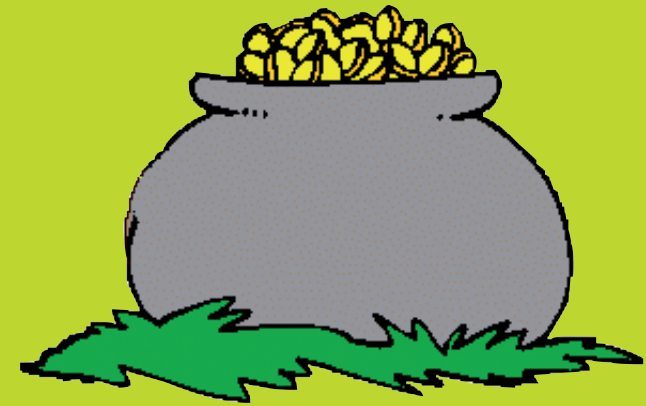

*Great value
for money.....*



FIREJET RANGE



The last range to be presented is our Firejet range: made 100% of cast iron, a great stove for heating smaller surfaces.

They all include secondary burn and ashtray for easier use.

The 409 and 309 MK II



409



309 MK II

Our Firejet line, is an up-market version of the budget stoves available. We include a good combustion, with primary and secondary air; all our models burn wood, turf or coal and the glass stays clean when well operated.

“Cold hand” handles are standard. The 309 MK II and the Tiny 209 can be delivered with small or high legs.

3 years Warranty.

All stoves can be fitted with an overhead / backboiler .

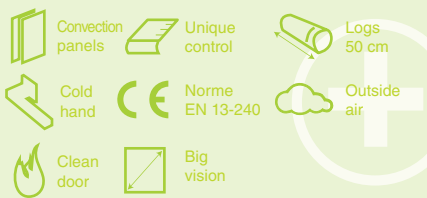

The 209

Tiny

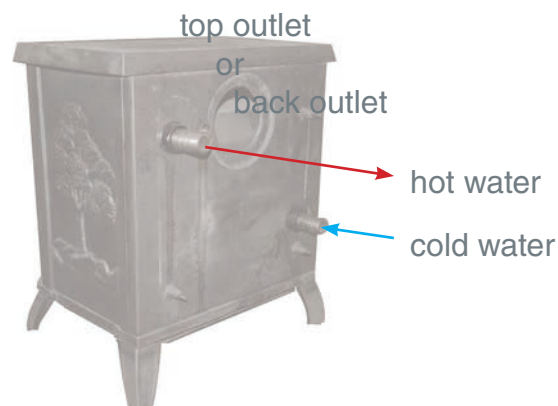

short legs
or
long legs

209 TINY

The Tiny is a favourite for smaller homes, often terrace houses. Where the living area is the kitchen, dining area and sitting area all together in one room - open plane.

This cast iron stove will heat a volume of 100 to 200 sq.meters. It can have an overhead/back boiler, heating 5 to 7 radiators, the flat top can be used for simmering, the generous size glass door will bring cheer to the living area. The stove burns wood, turf, coal and all types of briquettes.

Customers have been heard to remark «My tiny is a dote».

The 309



Universal Boiler (tested up to 6 bars)

Overhead - "V" Shaped

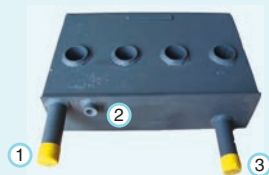

Overhead / Back "Γ" Shaped

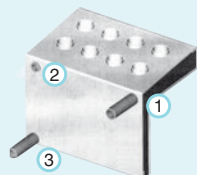

- ① Flow
- ② Sensor pocket holder
- ③ Return

Pressure maxi 3 bars

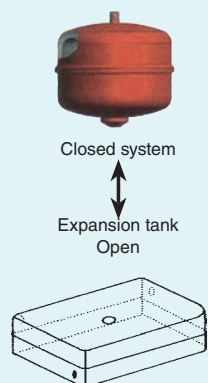

Anti-thermosiphon valve



Accessories necessary to complete the installation

Thermostat/aquastat



Pressure Gauge Purger Safety Valve



Immersion heater

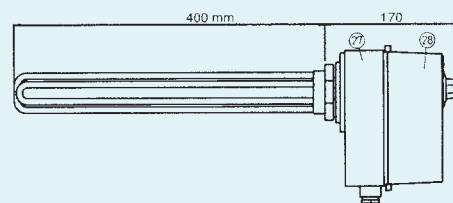

Flue pipe thermometer



Thermostatic release safety valve

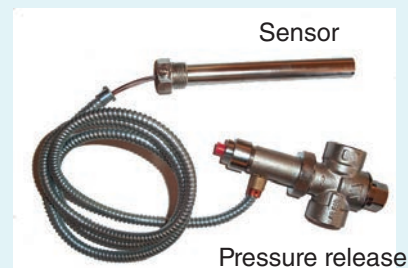

Flowbox

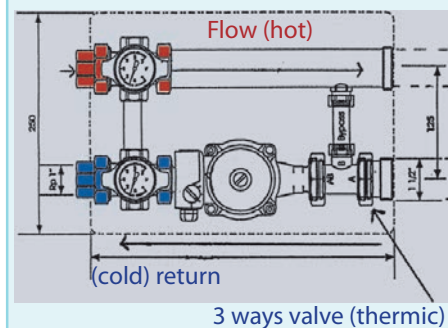

Automatic refill

When the pressure drops

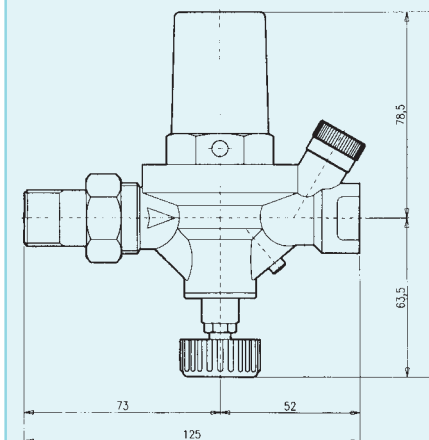

Domestic water heater

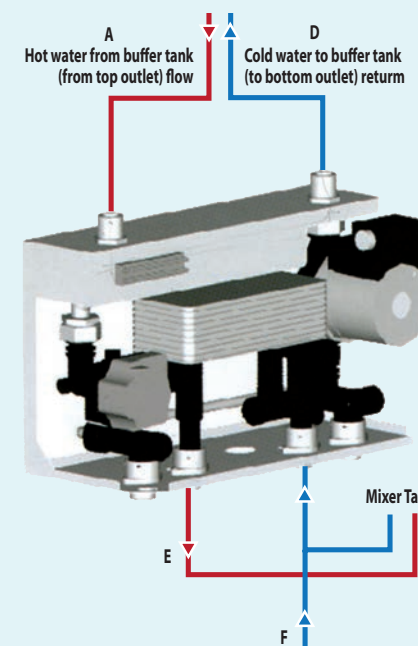

ALTERNATIVE HOME HEATING - exploiting what is all around us - wood, sun, electricity (off peak rates).
Existing installations can be modernised and made more efficient by using new technology to avoid wasting waste.

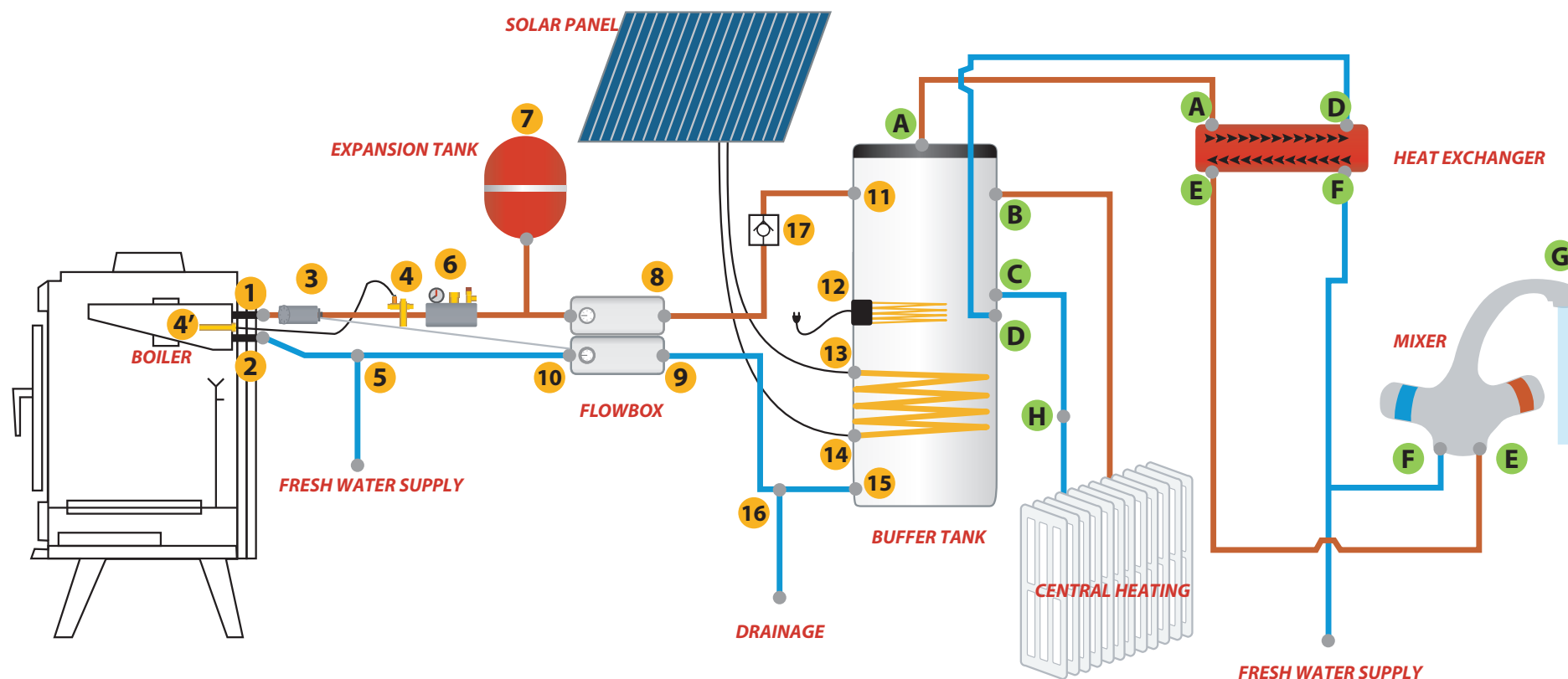

PRODUCTION



- | | |
|-----------------------------------|--|
| 1) Flow (hot water) | 8) Bypass |
| 2) Return (lukewarm) | 9) 3 way valve (thermic) |
| 3) Thermostat/aquastat | 10) pump |
| 4) Pressure release (overheating) | 11) Hot water flow to buffer tank |
| 4') Sensor | 12) Electric element |
| 5) Automatic refill | 13) Closed circuit |
| 6) Pressure gauge Purger | 14) for solar heating |
| Safety valve | 15) Return flow to boiler |
| 7) Expansion tank | 16) Drainage |
| | 17) Anti-thermosiphon valve (System open tank) |

DISTRIBUTION

- | |
|--|
| A) Hot water flow to heat exchanger |
| B) Hot water flow to central heating |
| C) Return to puffer tank from central heating circuit |
| D) Return from heat exchanger |
| E) Flow – domestic hot water from heat exchanger |
| F) Domestic cold water to mixer tap and heat exchanger |
| G) Spout of mixer (hot or cold water) |
| H) Pump (return from central heating circuit) |

IMPORTANT : ABOVE DESIGN IS ONLY A GUIDE ; FINAL DESIGN MUST BE CARRIED OUT BY HEATING SPECIALIST

www.cashin-france.com

	Model	Out put (kw)	Volume (m ³)	Log (cm)	CO (%)	(%)	Weight (kg)	Diameter of flue (cm)
	C 5	10	450	50	0,29	>80	250	150
	C 4	9	400	50	0,08	>80	201	150
	C 3	9	350	50	0,12	>80	187	150
	C 2	6,5	200	45	0,08	>70	150	150
	T 5	10	450	50	0,29	>80	250	150
	T 4	9	400	50	0,08	>80	201	150
	T 3	9	350	50	0,12	>80	187	150
	T 2	6,5	200	45	0,08	>70	150	150
	409	10	400	40	0,16	>70	161	150
	309 MKII	6	250	50	0,3	>70	125	150
	209 TINY	5	200	40	0,3	>70	100	150

Notes

[illegible]



ZA Les Grands Prés
BP 29 - F - 68370 ORBEY

Tél. + 33 3 89 71 26 67
Fax + 33 3 89 71 26 62

www.cashin-stoves.com



Ireland
Grand Britain
Greece
Baltic States
Belgium
Swiss
Italy
Germany
France